

This drawing may contain: Ordnance Survey material by permission of Ordnance Survey on behalf of the Controller of Her Majesty's Stationery Office © Crown Copyright 2019. All rights reserved. Reference number 0100031673.

PROJECT TITLE
Southend United - Fossetts Farm

OS Open data / © Natural England / © DEFRA / © DECC / © English Heritage.
Aerial Photography - ESRI, DigitalGlobe, GEOEye, i-cubed, USDA FSA, USGS, AEX, Getmapping, Aerogrid, IGN, IGP, swisstopo, the GIS User Community

REV.	DESCRIPTION	APP. DATE
04	Issued for Planning - Consultation Amendments	MW 29.03.21

ISSUED BY	London	T: 020 7467 1470
DATE	17 Sept 2020	DRAWN AK
SCALE@A3	1:2,000	CHECKED NB
STATUS	Planning	APPROVED MW

DRAWING TITLE
Development Envelope Dimensions
Parameter Plan

No dimensions are to be scaled from this drawing.
All dimensions are to be checked on site.
Area measurements for indicative purposes only.

© LDA Design Consulting Ltd. Quality Assured to BS EN ISO 9001 : 2015

DWG. NO
FOF-LDA-XX-XX-XX-DR-N-ST-00007

Sources Ordnance Survey

Z:\17132_SOUTHEND UNITED FOOTBALL CLUB_MASTERPLAN\CAD\DRAWINGS\PARAMETER PLANS\FOF-LDA-XX-XX-XX-DR-N-ST-00007.DWG

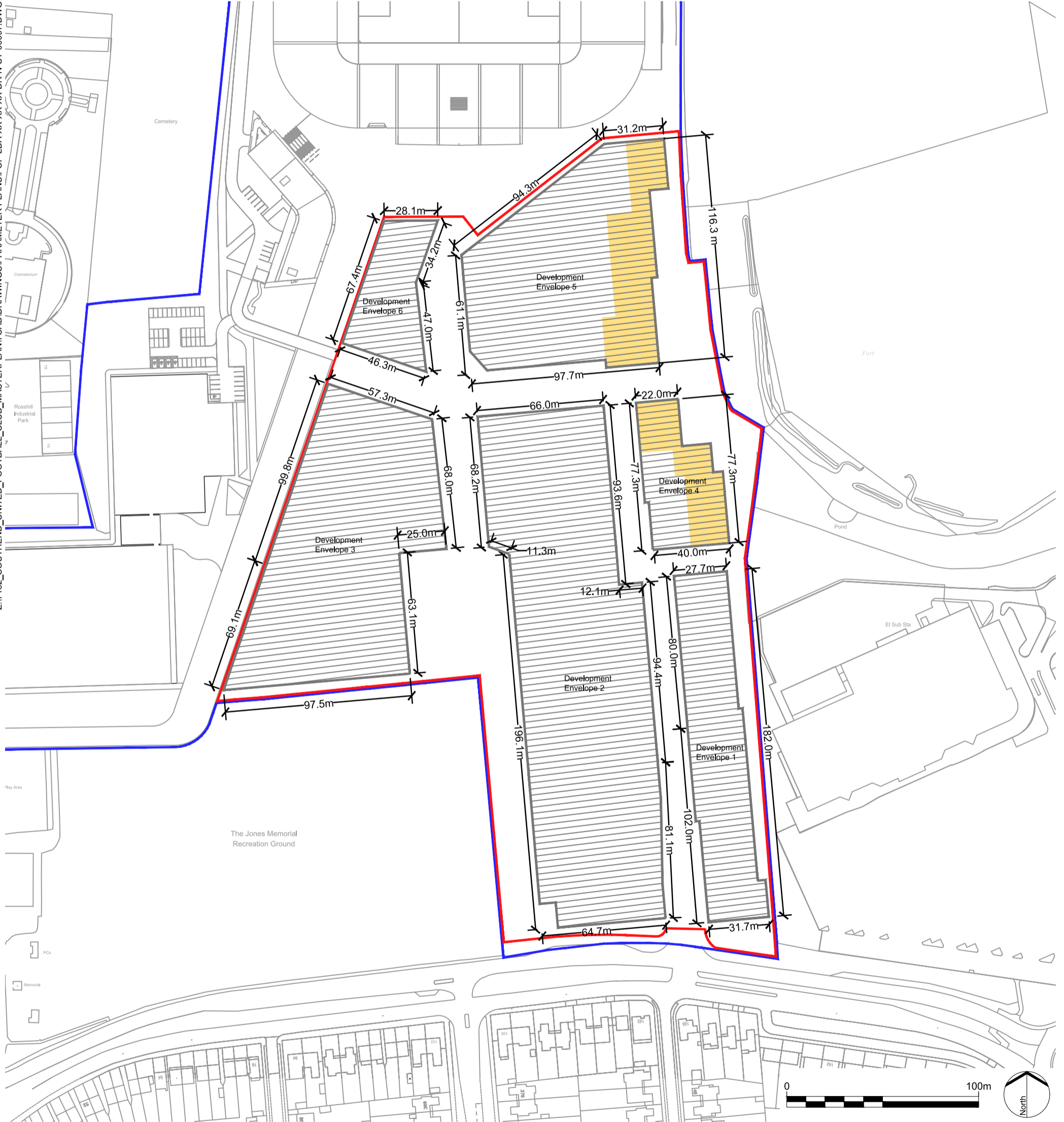

- LEGEND**
- Outline Area of Hybrid Planning Application
 - Hybrid Planning Application Boundary
 - Development Envelope
 - Area of Restricted Building Facade Length

- Notes**
1. Within the identified 'Areas of Restricted Building Facade Length' in Development Envelope 4 and Development Envelope 5, the eastern building facade for buildings of 2 storeys or more should not exceed 35 metres in length.